

Zigbee Push Dimmer

Product description:

- Make your installation become intelligent with our Zigbee Dimmer.
- Optimal dimming for Scan Products lighting products – Always check the latest and updated dimmer overview on our home page: www.scan-products.com
- Works with most of the common dimmable LED products on the market.
- Integrated Zigbee 3.0 communication module, compatible with leading Zigbee Gateways*, such as Philips Hue and Samsung SmartThings. Google Home / Alexa with compatible Gateways.
- Control voltage from 8-230V even enable operation using push button switch.
- Can be mounted in most of the common European installation boxes.
- The dimmer even has a memory function.



Technical data:

Size:	45x45x20 mm
Voltage:	100-240VAC 50 Hz
Max. load at 230V:	200W LED 200W Capacitive 400W Resistive
Max .output current:	1,8A
Control voltage:	8-230V AC/ DC
Dimming method:	Trailing edge
Protection:	IP20
Material:	Plastic
Approvals:	CE

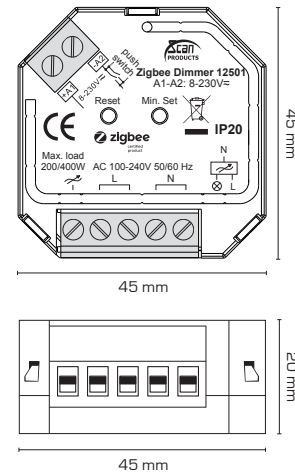

Item no.:	EAN no.:
12501	5713080125017
12437	5713080124379
	DIN rail mounting bracket

Wiring diagram

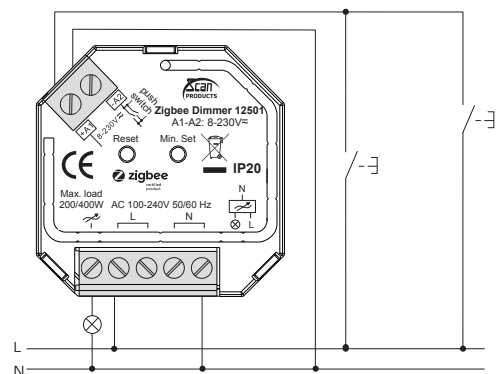

*We recommend performing a test setup with the desired Gateway, due to different firmware and hardware versions. This is to ensure 100% compatibility.

